

WELCOME TO

Het Slotervaart

Het Slotervaart is the place for innovative, healthcare related and communal organisations. It accommodates more than 30 professional organisations, offering primary and secondary healthcare and education. After the completion of the Rooftop Offices, Het Slotervaart consists of approximately 52,000 sqm LFA. Het Slotervaart is part of a dynamic Healthcare Hub within the vibrant urban district 'De Plantijn' in Amsterdam. This makes it a very attractive business climate for medical-related companies.

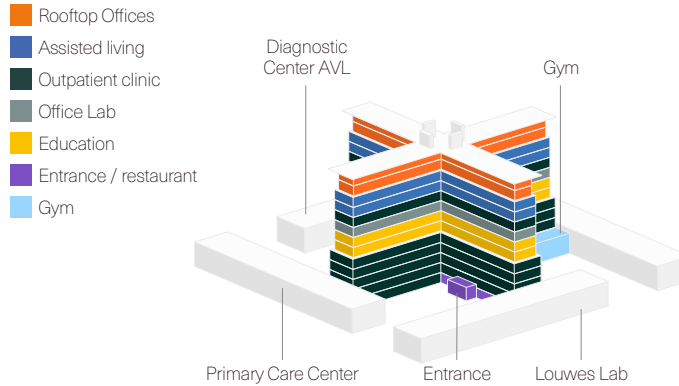

Sustainability at heart

We prioritise sustainability while transforming this city icon, with features like an A++ energy label.



Triple glass



LED lighting

A++ Renovated with energy class A++



Solar panels



Central systems renewed: gasless and air heat pumps





Please contact our team for more information:

- ✉ info@slotervaart.com
- ☎ +31 (0)85 114 7960
- 🌐 www.slotervaart.com

📍 Louwesweg 6
1066 EC Amsterdam
Netherlands



A Zadelhoff initiative

HET SLOTERVAART

Office Lab

Office Lab is located on 7th floor of Het Slotervaart, it offers units of 35 sqm and 50 sqm LFA. Experience the convenience of a turn-key office and practice space, allowing you to save both time and investment. The office furniture is included in the lease. Engage with socially-minded organisations and create valuable connections and meaningful networking opportunities. Office Lab is a collaborative and inspiring work environment.

Innovative healthcare and social environment

Flexible contract terms

Full service concept including: cleaning, waste disposal and full maintenance

Shared facilities: an equipped pantry, meetings rooms and more

Available from Q2 2025

Prices on request

Scan for more photos, floor plans and additional Office Lab information



Delivery Level

- 🔊 Lighting plan controlled by detectors
- 🔑 Turn-key ready to use
- 👤 Central heat and cold generation including ventilation
- 🪑 Fully equipped workstations
- 🚒 Sprinkler and fire alarm system
- ⚙️ Electronic entry system
- 📄 Automatic sunscreens
- 📄 Triple glass
- 📶 WiFi

Tenant benefits

- 👥 A community with 30+ healthcare professionals
- 🏋️ A full service gym on the ground floor
- 🅅 A spacious parking garage with e-charging
- 🚶 Easily accessible by bike, car and public transport
- ☕ Shared facilities: reception, coffee bar and meeting spaces

