

FOR LEASE

UTRECHT ROELANTDREEF 9-10

BoekenVoordeel

Shoppingcenter
Overvecht

DEMOGRAPHIC FACTS



359,370 INHABITANTS



437,623 INHABITANTS
(RADIUS OF 15 MINUTES)



€ 38,900
DISPOSABLE INCOME



€ 43,000 NATIONWIDE AVERAGE
DISPOSABLE INCOME



OBJECT IN DETAIL

ROELANTDREEF 9-10 IN UTRECHT



Footfall
5,400



Size
188.94 sqm



Rent
EUR 85,000

LOCATION

The property is located in the direct vicinity of Lucardi, Blokker, Etos, Specsavers, Hunkemöller, vanHaren, T-Mobile, Hema.

SIZE

Approx. 188.94 sqm gross floor area ground floor.

FRONTAGE

Approx. 10 meters.

RENTAL LEVEL

EUR 85,000 per annum exclusive of VAT.

SERVICE CHARGES IN ADVANCE

PM.

PROMOTION COSTS IN ADVANCE

PM.

LEASE TERM

5 years + n * 5 extension years.

RENTAL PAYMENT

Quarterly, in advance.

OBJECT IN DETAIL

ROELANTDREEF 9-10 IN UTRECHT

CONTRACT COMMENCEMENT DATE

To be agreed upon.

LEASE CONTRACT

Standard lease contract Lessor, based on the ROZ-model 2012.

SECURITY

Bank guarantee based on 3 months' rent, service charges and promotion costs plus VAT.

INDEXING

Yearly, for the first time one year after commencement date, to conform with the 'maandprijsindexcijfer' (CPI), All Households on most recent time basis (2015=100).

STATE OF DELIVERY

To be agreed upon.
Lessor is leasing the unit in shell state.

FURTHER CONDITIONS

To be agreed upon.

RESTRICTIONS

Subject to board approval Lessor.

FEE

We have a letting instruction for the above-mentioned retail property.

OBJECT IN DETAIL

ROELANTDREEF 9-10 IN UTRECHT

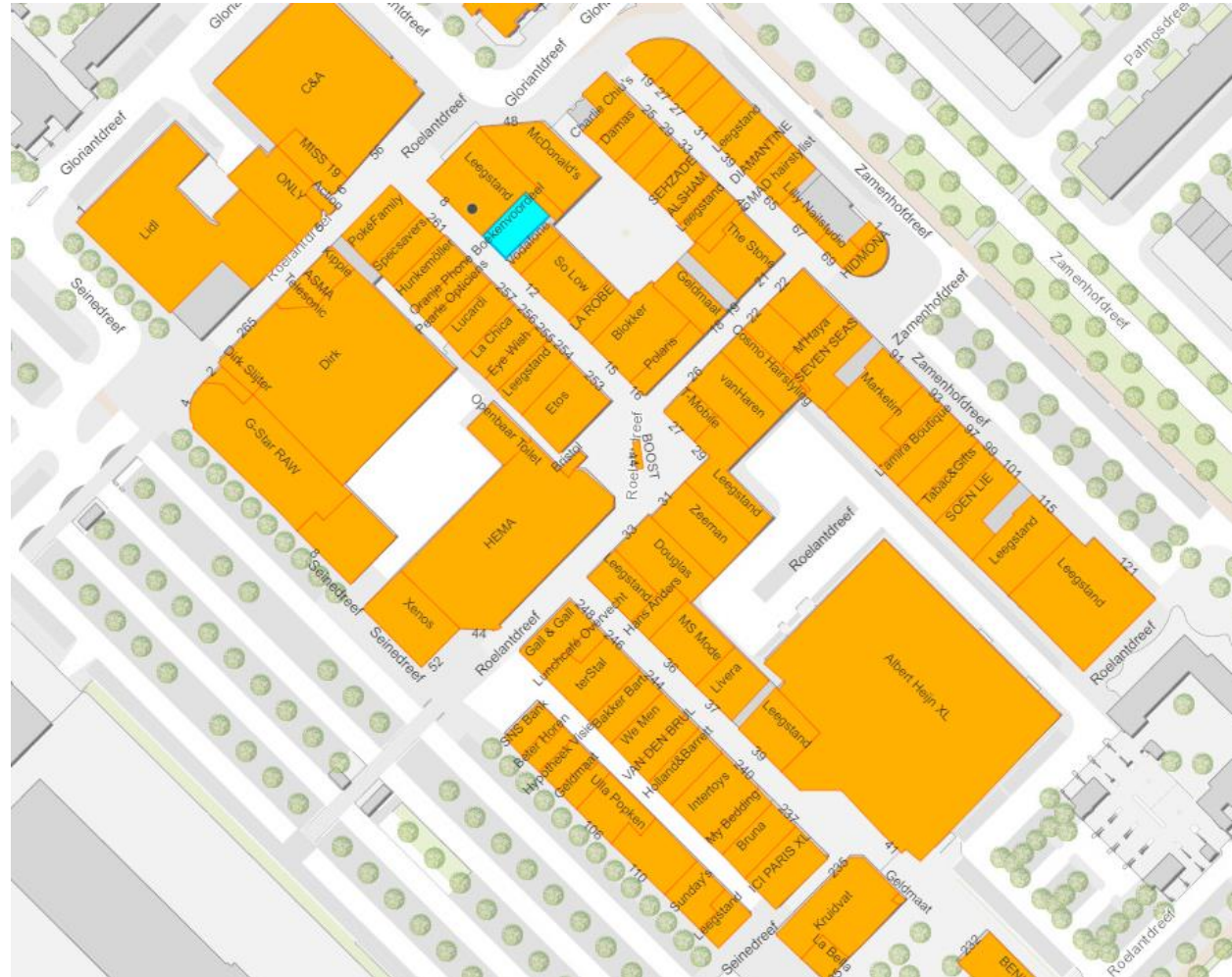

The information contained in this communication is confidential, may be privileged and is intended for the exclusive use of the above named addressee(s). If you are not the intended recipient(s), you are expressly prohibited from copying, distributing, disseminating, or in any other way using any information contained within this communication. If you have received this communication in error please contact the sender by telephone or by response via mail.

OBJECT IN DETAIL

ROELANTDREEF 9-10 IN UTRECHT

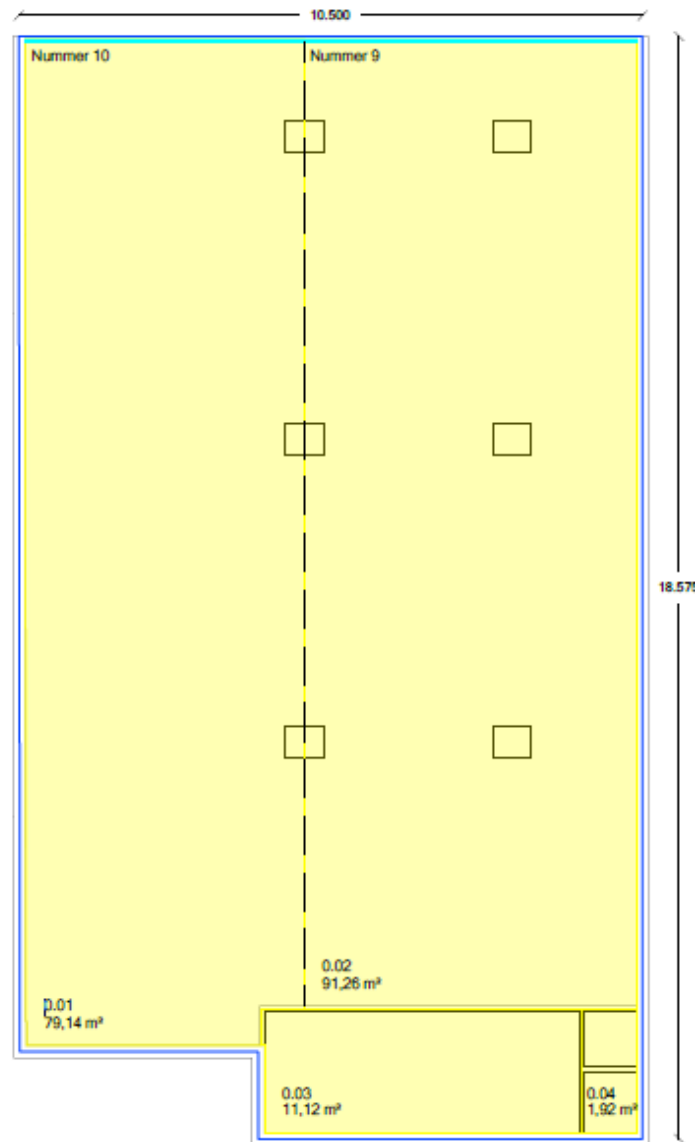

The information contained in this communication is confidential, may be privileged and is intended for the exclusive use of the above named addressee(s). If you are not the intended recipient(s), you are expressly prohibited from copying, distributing, disseminating, or in any other way using any information contained within this communication. If you have received this communication in error please contact the sender by telephone or by response via mail.

CONTACT

Cushman & Wakefield is the leading Dutch real estate service provider, offering comprehensive advice on all aspects of retail property. We have unrivalled knowledge of the market, which has been built over many years through very strong contacts with institutional landlords, private investors and developers as well as national and international retailers. To maintain and expand our position we actively use the existing expertise within Retail Agency, and we strive for a proactive, solid and sound advice, whether it is the letting of an individual shop, providing advice on an estate, or acting on behalf of retailers.

Our Retail Agency Service Line provides:

- Leasing
- Tenant Representation
- Rent Reviews / Lease Renewals
- Shopping Centre Leasing Management



PIETER MAZEREEUW

Senior Consultant

T: +31 (0)20 800 2000

M: +31 (0)6 2257 2896

pieter.mazereeuw@cushwake.com

CUSHMAN & WAKEFIELD

UNStudio

Gustav Mahlerlaan 362-364

1082 ME AMSTERDAM

www.cushmanwakefield.nl

DISCLAIMER

This report has been produced by Cushman & Wakefield for use by those with an interest in commercial property solely for information purposes. It is not intended to be a complete description of the markets or developments to which it refers. The report uses information obtained from public sources which Cushman & Wakefield believe to be reliable, but we have not verified such information and cannot guarantee that it is accurate and complete. No warranty or representation, express or implied, is made as to the accuracy or completeness of any of the information contained herein and Cushman & Wakefield shall not be liable to any reader of this report or any third party in any way whatsoever. All expressions of opinion are subject to change.

© 2016 Cushman & Wakefield. All rights reserved.

Our prior written consent is required before this report can be reproduced in whole or in part